

SHOWER

ZT7788

Colonna doccia completa di termostatico esterno. / Shower column with exposed thermostatic mixer.



Colonna doccia completa di termostatico esterno, soffione Z94312 Ø 250 mm e doccetta in ABS Z94727 a getto fisso.
Per versioni in finitura, doccetta Z94177
Water Saving - portata d'acqua uguale o inferiore a 9 l/min.

Shower column with exposed thermostatic mixer, shower head Z94312 Ø 250 mm and ABS handshower Z94727 simple jet.
Handshower Z94177 on finishing versions
Water Saving - water flow rate of 9 l/min or less.

SHOWER

ZT7788

Finiture / Finishes



Cromo / Chrome



Nickel Spazzolato / Brushed Nickel

C3



Nickel Lucido / Polished Nickel

C8



Oro / Gold

C40

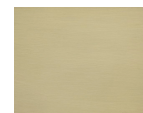

Oro spazzolato / Brushed Gold

C41

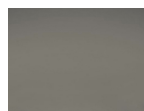

Metal Black / Metal Black

C50

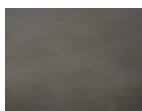

Metal Black spazzolato / Brushed Metal Black

C51



Bianco Opaco Goffrato / Embossed Matt White

W1



Nero Opaco Goffrato / Embossed Matt Black

N1

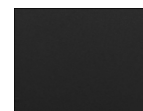

Nero opaco / Matt black

N6



Glossy gesso / Glossy gesso

J3



Pearl cipria / Pearl cipria

K7



Pearl chili / Pearl chili

R6



Pearl salvia / Pearl salvia

V7



Matt mirto / Matt mirto

V8

Note / Notes

SHOWER

ZT7788

Disegno Complessivo / Overall Drawing

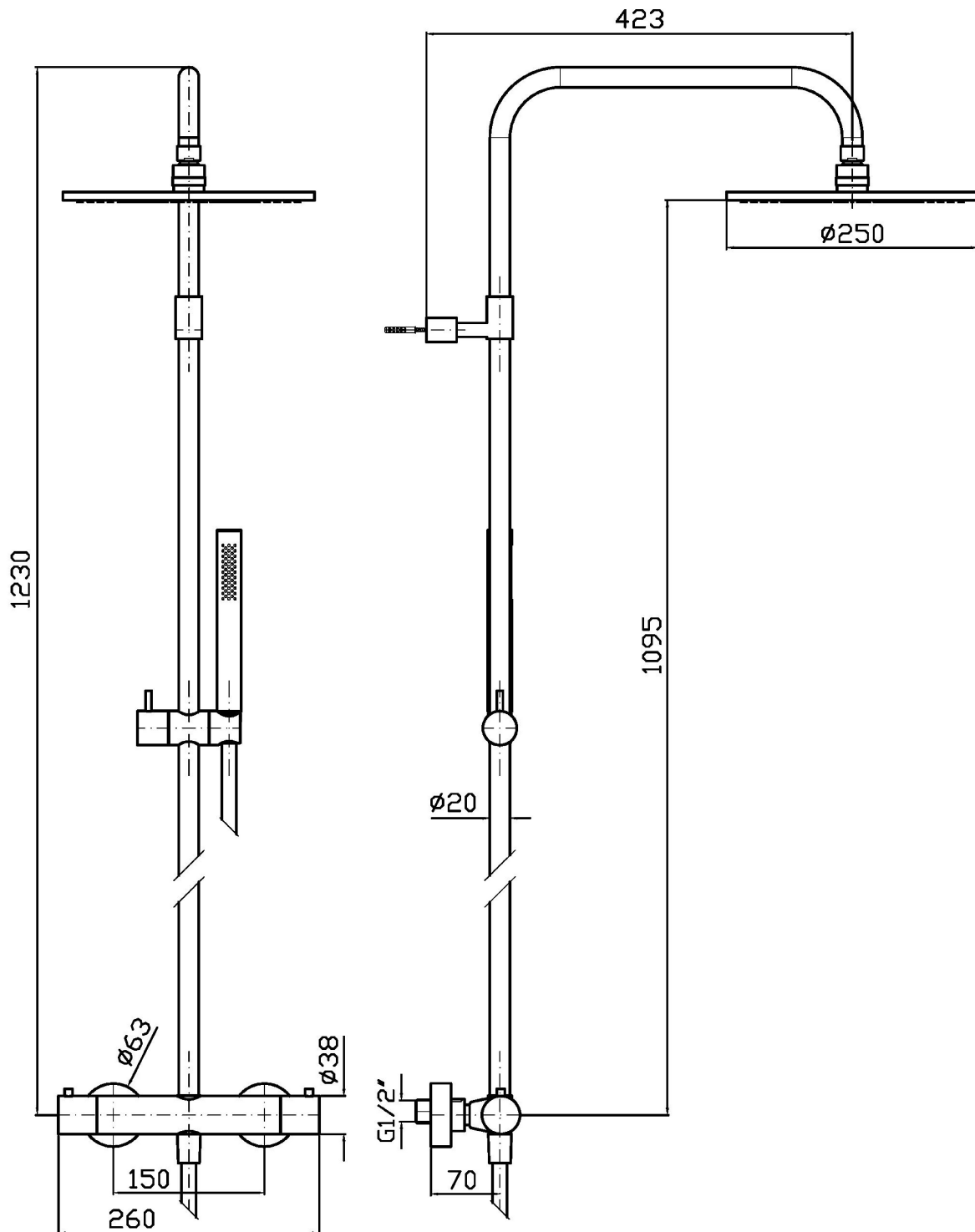

SHOWER

ZT7788

Esplosi / Exploded

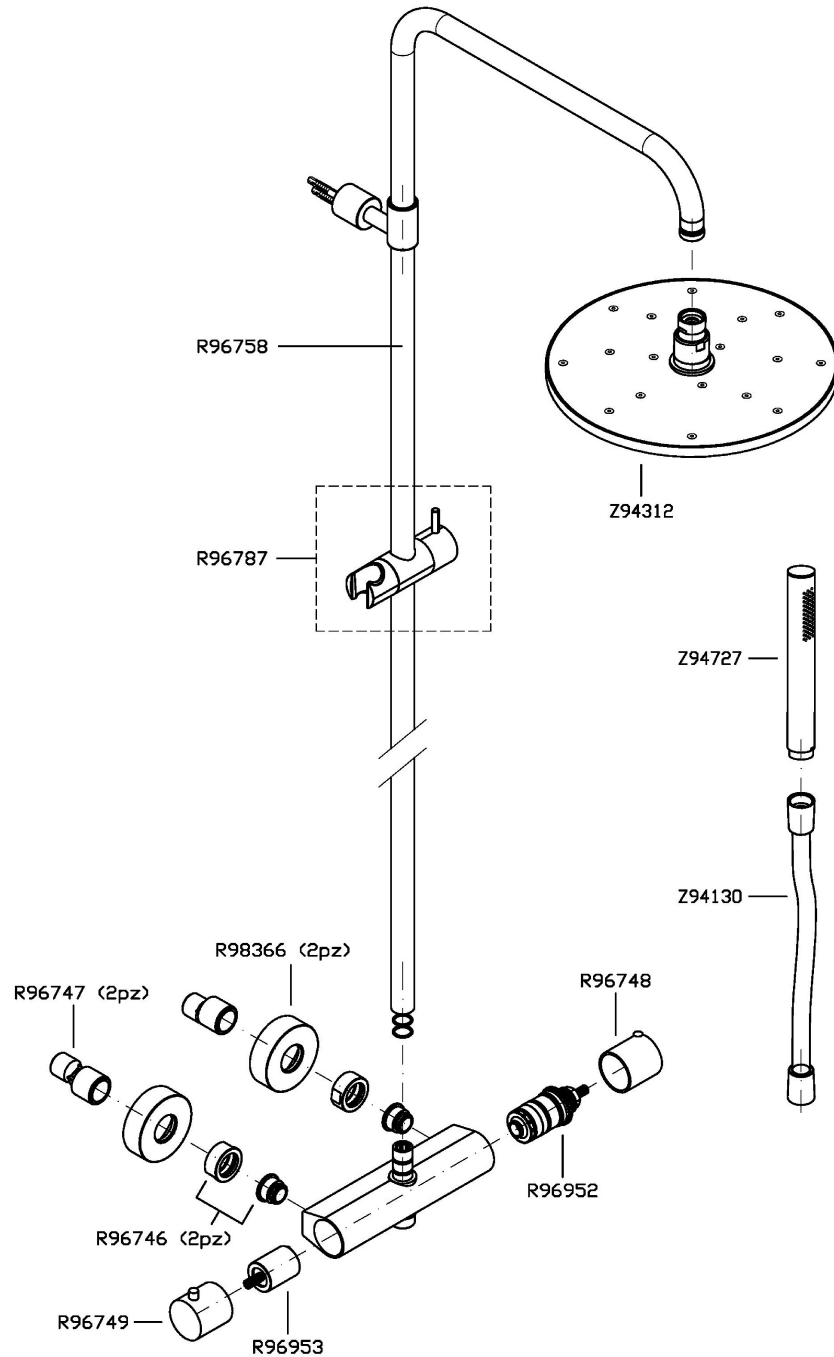

SHOWER

ZT7788

Portate / Flowrates (lt/min)

PRESSIONE PRESSURE	1 BAR	2 BAR	3 BAR	4 BAR	5 BAR
P1 SOFFIONE SHOWER HEAD	8,5	9	9	9	9
P2 DOCCETTA HANDSHOWER	6,1	8,5	8,6	9	9
P3					
P4					
P5					

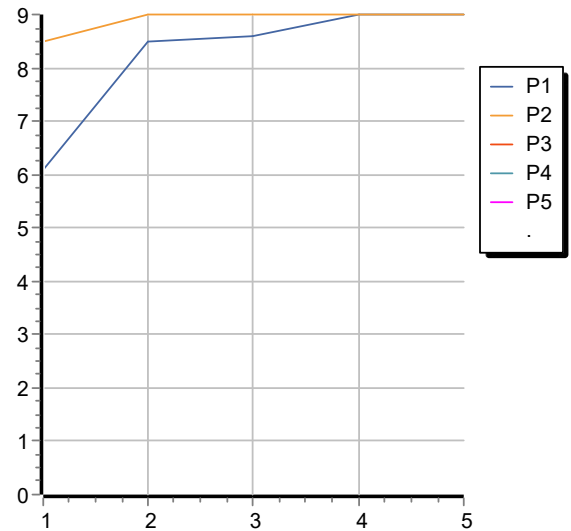

SHOWER

ZT7788

Pesi e Misure / Weights and Sizes

Peso (Kg) Weight (lb)	6,19 (Kg)	13,65 (lb)
Volume test (dc3) - (in3)	87,00 (dc3)	5309,06 (in3)
h (mm) - (in)	110,00 (mm)	4,33 (in)
L1 (mm) - (in)	430,00 (mm)	16,93 (in)
L2 (mm) - (in)	1180,00 (mm)	46,46 (in)

