

Marchio / Brand ZUCCHETTI

Classe / Class WW

PAN

ZT28646

Termostatico incasso doccia con deviatore 2/3 vie. / Built-in therm. shower mixer, 2/3 way diverter.



Termostatico incasso doccia da 1/2" e deviatore a 2/3 vie con apertura/chiusura acqua.

1/2" built-in thermostatic shower mixer and 2/3 way diverter with water on/off function.

R97810

Parte incasso termostatico 2 vie / Built-in part -
2 way thermostatic mixer



R97815

Parte incasso termostatico 3 vie / Built-in part -
3 way thermostatic mixer



Finiture / Finishes

							
Cromo / Chrome	Nickel Spazzolato / Brushed Nickel	Nickel Lucido / Polished Nickel	Oro / Gold	Oro spazzolato / Brushed Gold	Metal Black / Metal Black	Metal Black spazzolato / Brushed Metal Black	Bianco Opaco Goffrato / Embossed Matt White
							
Nero Opaco Goffrato / Embossed Matt Black	Nero opaco / Matt black						

PAN

ZT28646

Disegno Complessivo / Overall Drawing

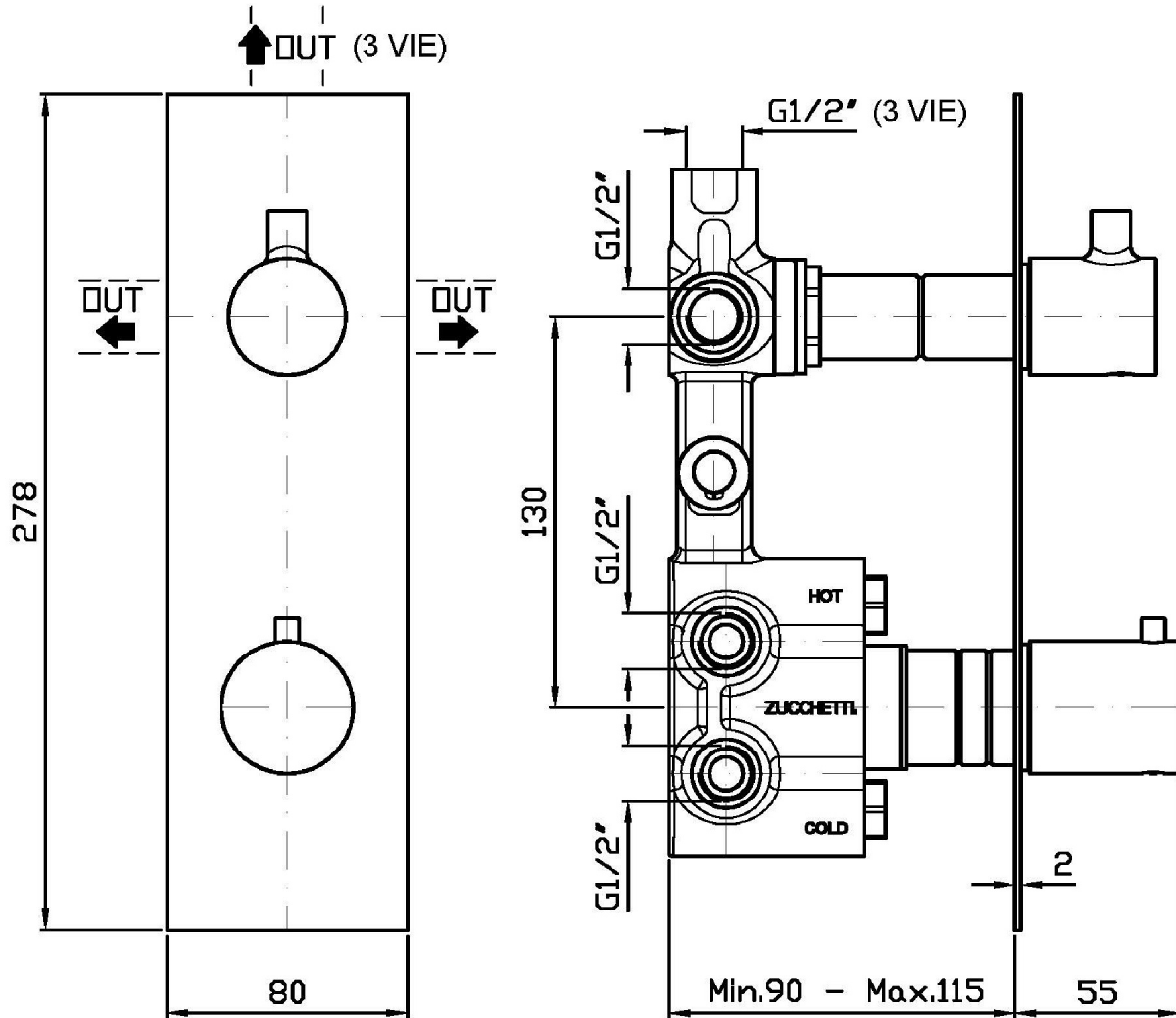

PAN

ZT28646

Esplosi / Exploded

R97416: PER DEVIATORE A 2 VIE R97810 (2 way diverter R97810)

R97417: PER DEVIATORE A 3 VIE R97815 (3 way diverter R97815)

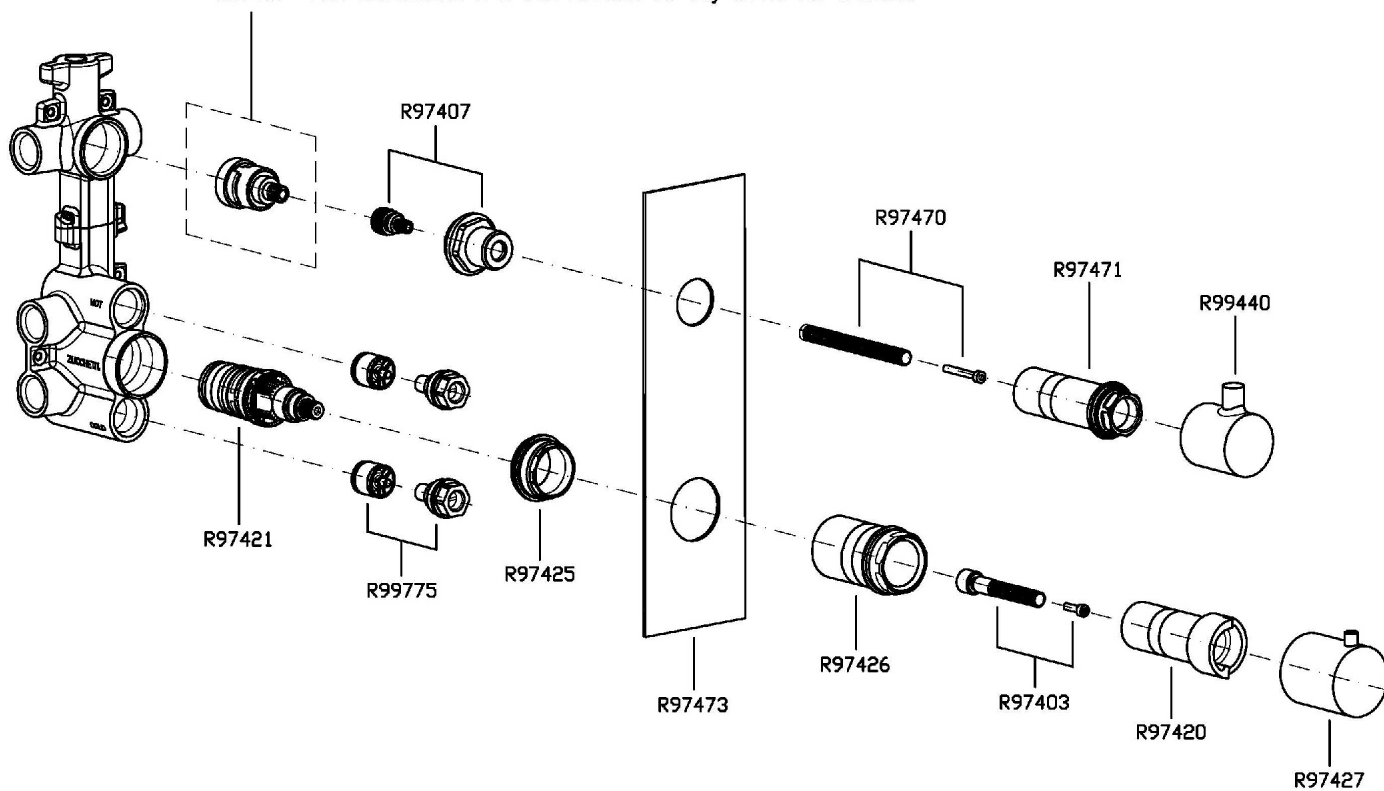

PAN

ZT28646

Certificazioni / Certifications

INGHILTERRA

UK APPROVAL KIWA

PAN

ZT28646

Portate / Flowrates (lt/min)

PRESSIONE PRESSURE	1 BAR	2 BAR	3 BAR	4 BAR	5 BAR
DEVIATORE	11,5	16,2	19,5	23,2	26
P1					
P2					
P3					
P4					
P5					

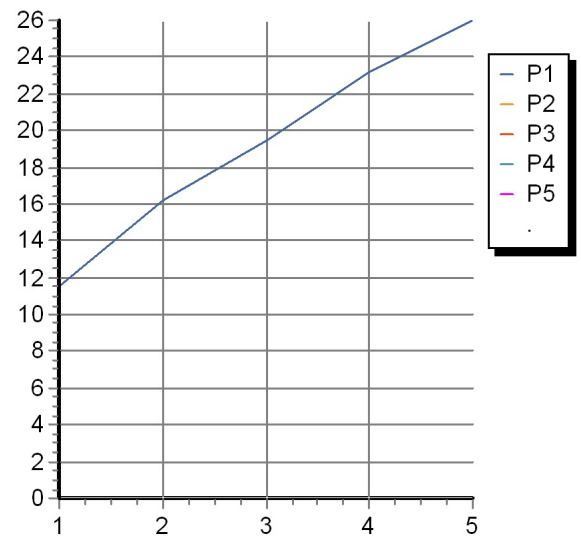

PAN

ZT28646

Pesi e Misure / Weights and Sizes

Peso (Kg) Weight (lb)	1,35 (Kg)	2,98 (lb)
Volume test (dc3) - (in3)	5,68 (dc3)	346,61 (in3)
h (mm) - (in)	75,00 (mm)	2,95 (in)
L1 (mm) - (in)	180,00 (mm)	7,09 (in)
L2 (mm) - (in)	420,00 (mm)	16,54 (in)

