

## SABLIER

ZSL557.X

Miscelatore monocomando lavabo, bocca prolungata. / Single lever basin mixer with extended spout.











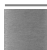

Miscelatore monocomando lavabo in acciaio inox AISI 316L, con bocca prolungata, aeratore, flessibili di collegamento, senza scarico.

Water Saving - portata d'acqua uguale o inferiore a 6 l/min.

Single lever basin mixer in AISI 316L stainless steel, with extended spout, aerator, flexible tails, without pop-up waste.

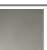
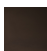
Water Saving - water flow rate of 6 l/min or less.

### Finiture / Finishes

|   |  |   |  |   |   |  |
|---|--|---|--|---|---|--|
|  X<br>Acciaio inox spazzolato / Brushed stainless steel |  XP21<br>Brushed PVD chocolate / Brushed PVD chocolate  |  XP31<br>Brushed PVD British gold / Brushed PVD British gold |  XP41<br>Brushed PVD gold / Brushed PVD gold          |  XP81<br>PVD Brushed Total Black / PVD Brushed Total Black |  XP91<br>Brushed PVD copper / Brushed PVD copper |  XS<br>Acciaio inox matt / Matt stainless steel |
|  XSP21<br>Matt PVD chocolate / Matt PVD chocolate       |  XSP31<br>Matt PVD British gold / Matt PVD British gold |  XSP41<br>Matt PVD gold / Matt PVD gold                      |  XSP81<br>Matt PVD total black / Matt PVD total black |  XSP91<br>Matt PVD copper / Matt PVD copper                |   |  |

## SABLIER

ZSL557.X

Disegno Complessivo / Overall Drawing

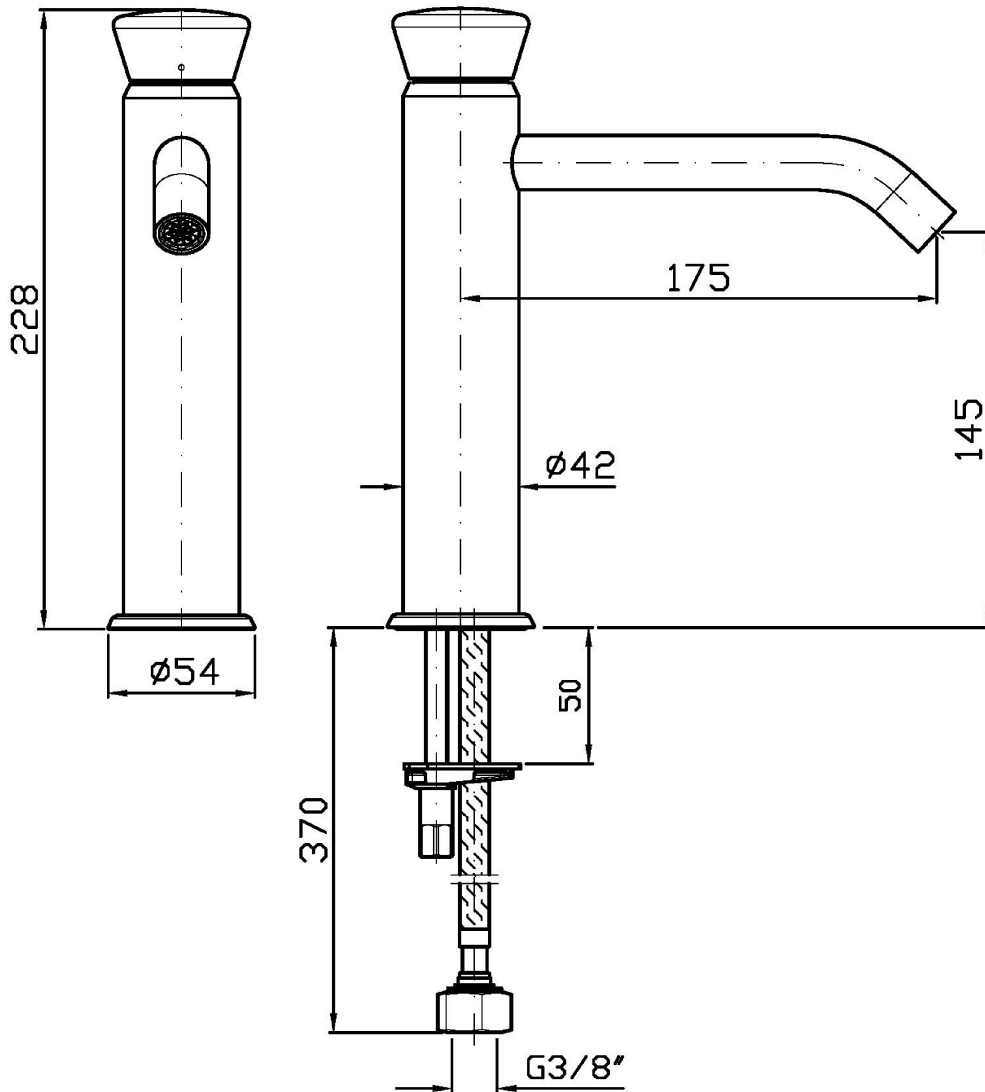

Note / Notes

## SABLIER

ZSL557.X

Portate / Flowrates (lt/min)

| PRESSIONE<br>PRESSURE | 1 BAR | 2 BAR | 3 BAR | 4 BAR | 5 BAR |
|-----------------------|-------|-------|-------|-------|-------|
| P1<br>LAVABO<br>BASIN | 3,8   | 4,5   | 4,7   | 4,8   | 5     |
| P2                    |       |       |       |       |       |
| P3                    |       |       |       |       |       |
| P4                    |       |       |       |       |       |
| P5                    |       |       |       |       |       |

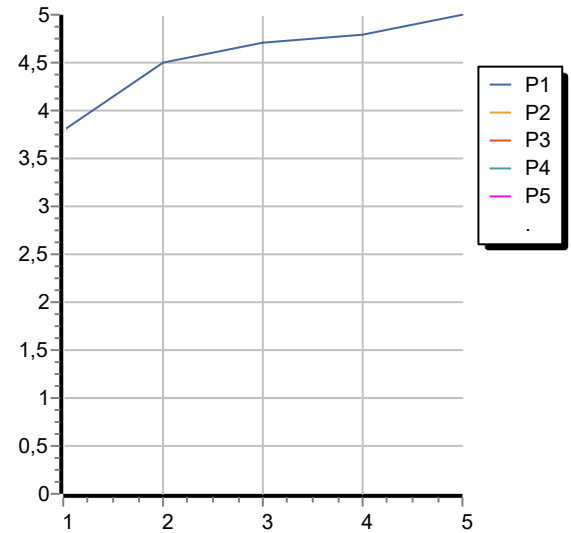

## SABLIER

ZSL557.X

Pesi e Misure / Weights and Sizes

|                               |               |                |
|-------------------------------|---------------|----------------|
| Peso ( Kg ) Weight ( lb )     | 1,60 ( Kg )   | 3,53 ( lb )    |
| Volume test ( dc3 ) - ( in3 ) | 11,01 ( dc3 ) | 671,87 ( in3 ) |
| h ( mm ) - ( in )             | 90,00 ( mm )  | 3,54 ( in )    |
| L1 ( mm ) - ( in )            | 335,00 ( mm ) | 13,19 ( in )   |
| L2 ( mm ) - ( in )            | 365,00 ( mm ) | 14,37 ( in )   |

