

## PAN

ZP6726











Rubinetto elettronico lavabo a batteria / Electronic basin mixer powered by batteries.

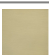

Rubinetto elettronico lavabo con alimentazione a batteria. Senza scarico. Con miscelazione meccanica.  
Water Saving - portata d'acqua uguale o inferiore a 6 l/min.

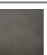
Electronic basin mixer powered by batteries, without pop-up waste. With mechanical water mixing.  
Water Saving - water flow rate of 6 l/min or less.

### Finiture / Finishes

 Cromo / Chrome	 C3 Nickel Spazzolato / Brushed Nickel	 C8 Nickel Lucido / Polished Nickel	 C40 Oro / Gold	 C41 Oro spazzolato / Brushed Gold	 C50 Metal Black / Metal Black	 C51 Metal Black spazzolato / Brushed Metal Black	 W1 Bianco Opaco Goffrato / Embossed Matt White
 N1 Nero Opaco Goffrato / Embossed Matt Black	 N6 Nero opaco / Matt black						

## PAN

ZP6726

Disegno Complessivo / Overall Drawing

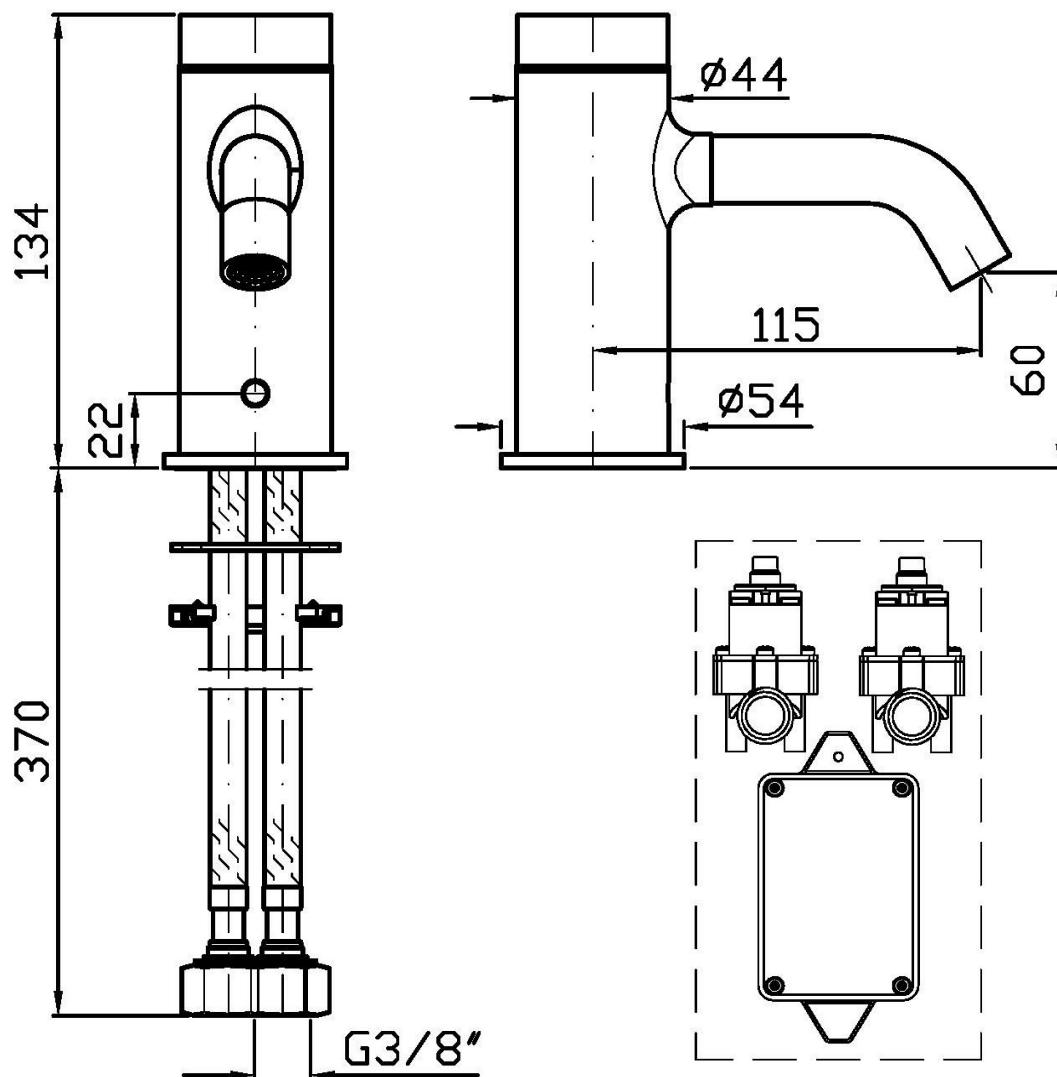

## PAN

ZP6726

Portate / Flowrates (lt/min)

PRESSIONE PRESSURE	1 BAR	2 BAR	3 BAR	4 BAR	5 BAR
P1 LAVABO BASIN	3,8	4,5	4,7	4,8	5
P2					
P3					
P4					
P5					

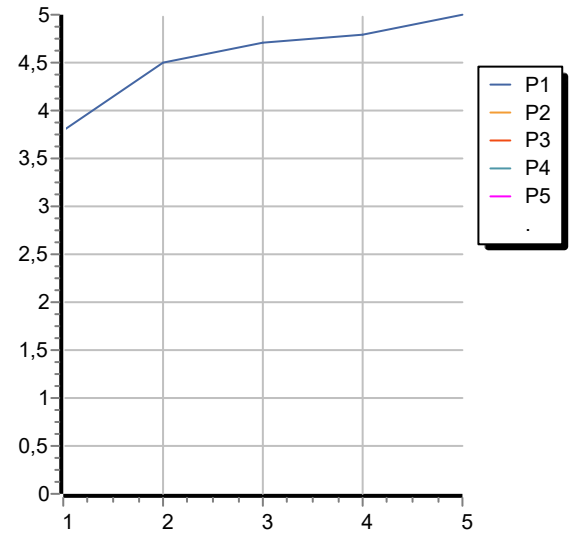

## PAN

ZP6726

Pesi e Misure / Weights and Sizes

Peso ( Kg ) Weight ( lb )	2,00 ( Kg )	4,41 ( lb )
Volume test ( dc3 ) - ( in3 )	7,50 ( dc3 )	457,68 ( in3 )
h ( mm ) - ( in )	90,00 ( mm )	3,54 ( in )
L1 ( mm ) - ( in )	250,00 ( mm )	9,84 ( in )
L2 ( mm ) - ( in )	333,00 ( mm )	13,11 ( in )

