

Marchio / Brand ZUCCHETTI

Classe / Class WW

OCTO X

ZOX5515.X

Batteria lavabo a 3 fori. / 3 hole basin mixer.



Batteria lavabo a 3 fori in acciaio inox AISI 316L, con aeratore, flessibili di collegamento, senza scarico.
Water Saving - portata d'acqua uguale o inferiore a 6 l/min.

3 hole basin mixer in AISI 316L stainless steel with aerator, flexible tails, without pop-up waste.
Water Saving - water flow rate of 6 l/min or less.

OCTO X

ZOX5515.X

Finiture / Finishes



X

Acciaio inox spazzolato /
Brushed stainless steel



XP21

Brushed PVD chocolate /
Brushed PVD chocolate



XP31

Brushed PVD British gold /
Brushed PVD British gold



XP41

Brushed PVD gold / Brushed
PVD gold



XP81

PVD Brushed Total Black /
PVD Brushed Total Black



XP91

Brushed PVD copper /
Brushed PVD copper

Note / Notes

OCTO X

ZOX5515.X Esplosi / Exploded

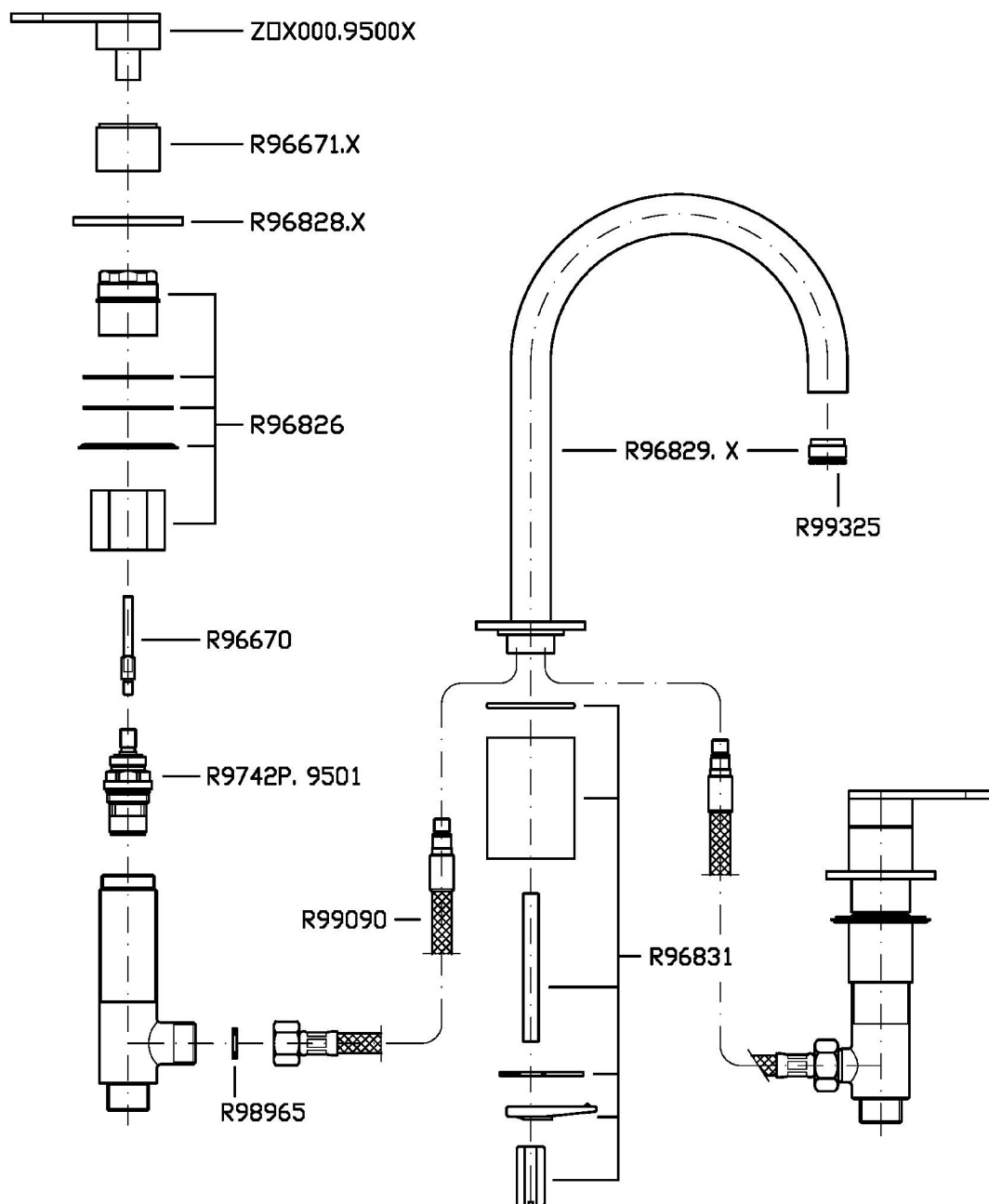

OCTO X

ZOX5515.X Portate / Flowrates (lt/min)

| PRESSIONE PRESSURE | 1 BAR | 2 BAR | 3 BAR | 4 BAR | 5 BAR |
|-----------------------|-------|-------|-------|-------|-------|
| P1 LAVABO BASIN | 3,9 | 4,6 | 4,8 | 4,9 | 5 |
| P2 | | | | | |
| P3 | | | | | |
| P4 | | | | | |
| P5 | | | | | |

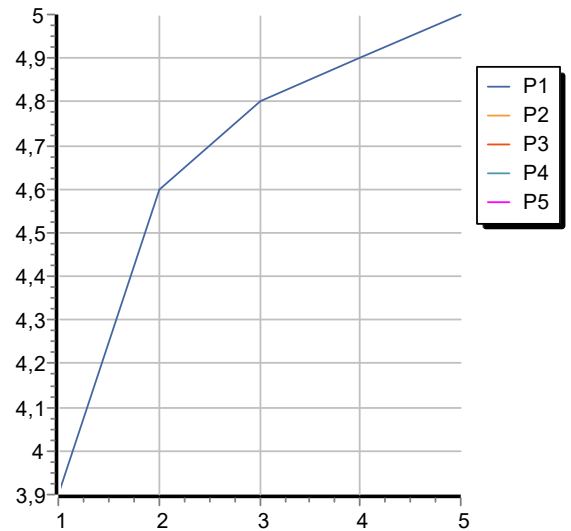

OCTO X

ZOX5515.X Pesì e Misure / Weights and Sizes

| | | |
|-------------------------------|---------------|----------------|
| Peso (Kg) Weight (lb) | 2,80 (Kg) | 6,17 (lb) |
| Volume test (dc3) - (in3) | 11,01 (dc3) | 671,87 (in3) |
| h (mm) - (in) | 90,00 (mm) | 3,54 (in) |
| L1 (mm) - (in) | 335,00 (mm) | 13,19 (in) |
| L2 (mm) - (in) | 365,00 (mm) | 14,37 (in) |

