

MEDAMEDA

ZMM096

Miscelatore monocomando incasso vasca-doccia. / Built-in single lever bath shower mixer.

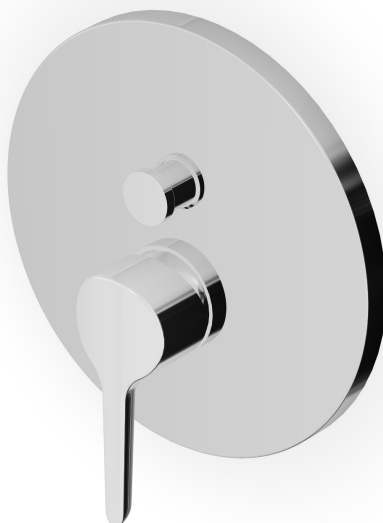

Miscelatore monocomando incasso vasca-doccia con deviatore, per corpo incasso universale Zetasystem R97800.











Built-in single lever bath shower mixer with diverter, for Zetasystem (R97800) universal built-in body.

R97800

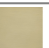
Zetasystem - Corpo incasso universale / Basin spout Medamede

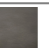

Finiture / Finishes

	 C3	 C8	 C40	 C41	 C50	 C51
Cromo / Chrome	Nickel Spazzolato / Brushed Nickel	Nickel Lucido / Polished Nickel	Oro / Gold	Oro spazzolato / Brushed Gold	Metal Black / Metal Black	Metal Black spazzolato / Brushed Metal Black
	 P31	 P81				
Nero Opaco Goffrato / Embossed Matt Black	Brushed PVD British gold / Brushed PVD British gold	Brushed total black PVD / Brushed total black PVD				

MEDAMEDA

ZMM096

Disegno Complessivo / Overall Drawing

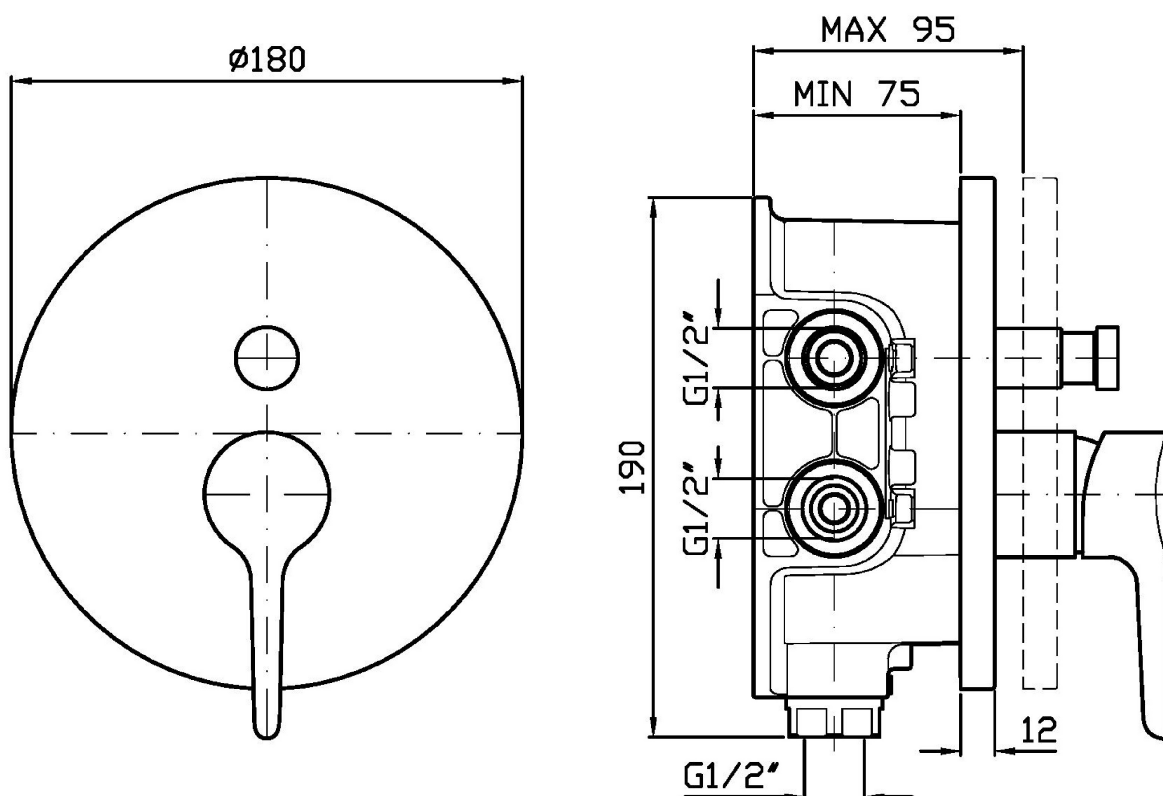

Note / Notes

MEDAMEDA

ZMM096

Esplosi / Exploded

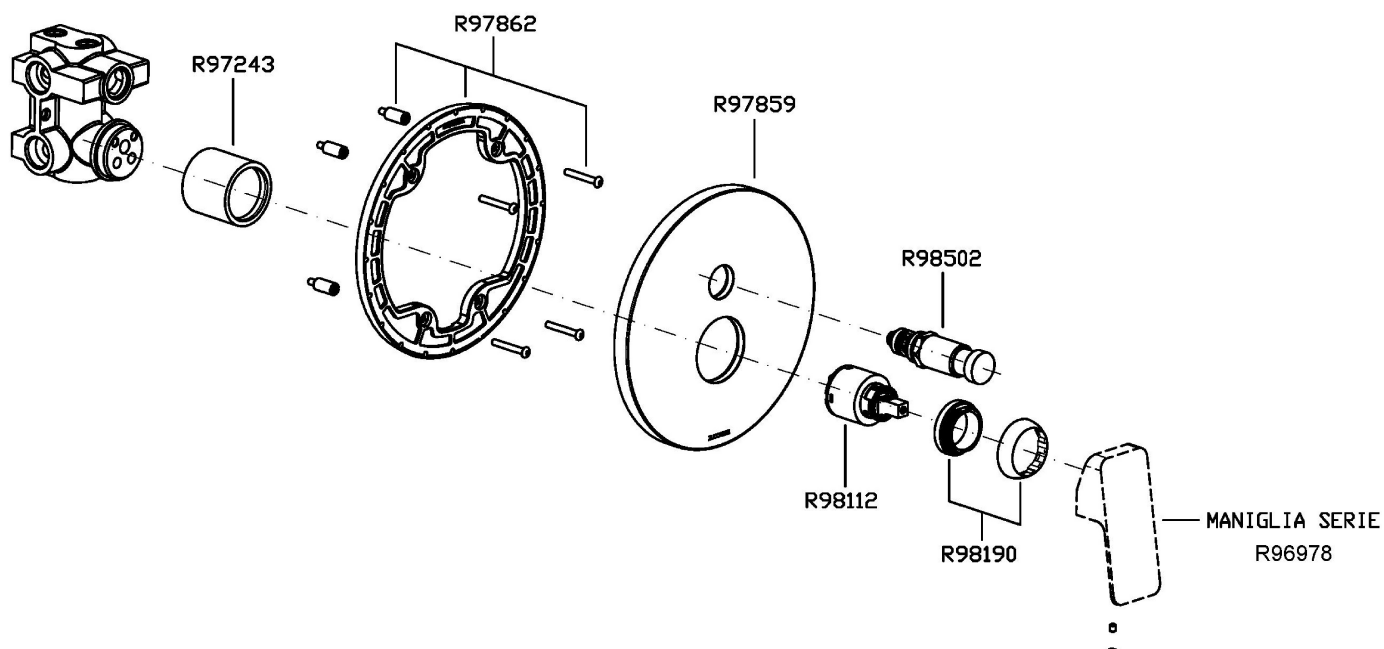

MEDAMEDA

ZMM096 Portate / Flowrates (lt/min)

PRESSIONE PRESSURE	1 BAR	2 BAR	3 BAR	4 BAR	5 BAR
USCITA PRIMARIA PRIMARY OUTLET <i>P₁</i>	12	17	22	25	28
USCITA SECONDARIA SECONDARY OUTLET <i>P₂</i>	11	16	21	24	27
<i>P₃</i>					
<i>P₄</i>					
<i>P₅</i>					

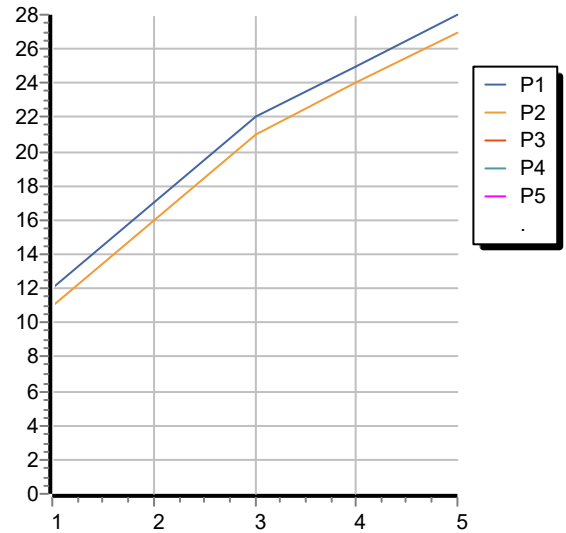

MEDAMEDA

ZMM096 Pesì e Misure / Weights and Sizes

Peso (Kg) Weight (lb)	3,30 (Kg)	7,28 (lb)
Volume test (dc3) - (in3)	7,50 (dc3)	457,68 (in3)
h (mm) - (in)	90,00 (mm)	3,54 (in)
L1 (mm) - (in)	250,00 (mm)	9,84 (in)
L2 (mm) - (in)	333,00 (mm)	13,11 (in)

