

ISY22

ZIS3756

Deviatore 2/3 vie. / 2/3 way diverter.



Deviatore 2/3 vie senza apertura/chiusura acqua, uscite da 1/2".

2/3 way diverter without water on/off function, 1/2" outlets.

R97830

Parte incasso deviatore 2 vie / Built-in part - 2 way diverter



R97835

Parte incasso deviatore 3 vie / Built-in part - 3 way diverter



Finiture / Finishes

						
Cromo / Chrome	Nickel Spazzolato / Brushed Nickel	Metal Black / Metal Black	Metal Black spazzolato / Brushed Metal Black	Nero opaco / Matt black	Blu mediterraneo / Mediterranean blu	PVD brushed chocolate / PVD brushed chocolate
						
Brushed PVD British gold / Brushed PVD British gold	Brushed PVD Copper / Brushed PVD Copper					

ISY22

ZIS3756

Disegno Complessivo / Overall Drawing

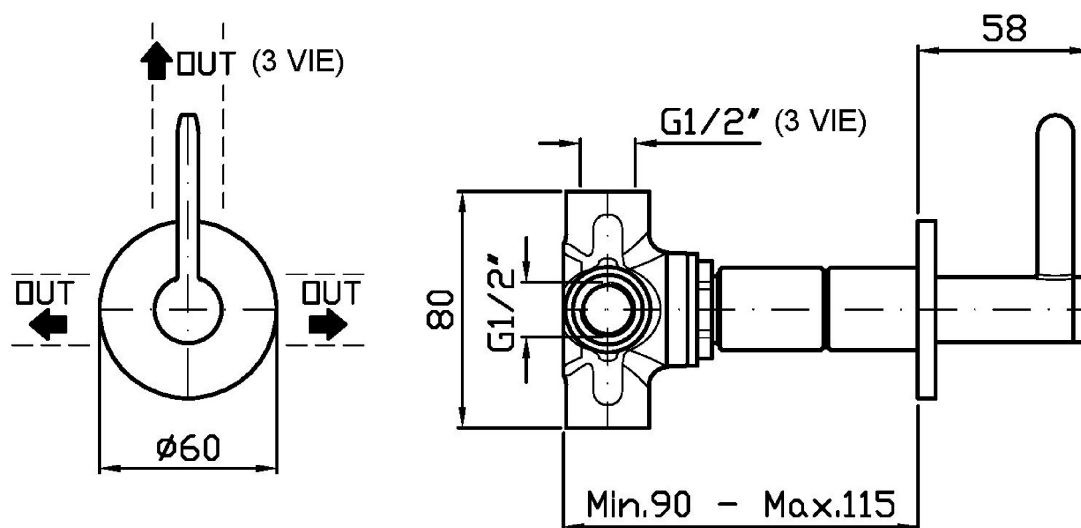

Note / Notes

ISY22

ZIS3756

Esplosi / Exploded

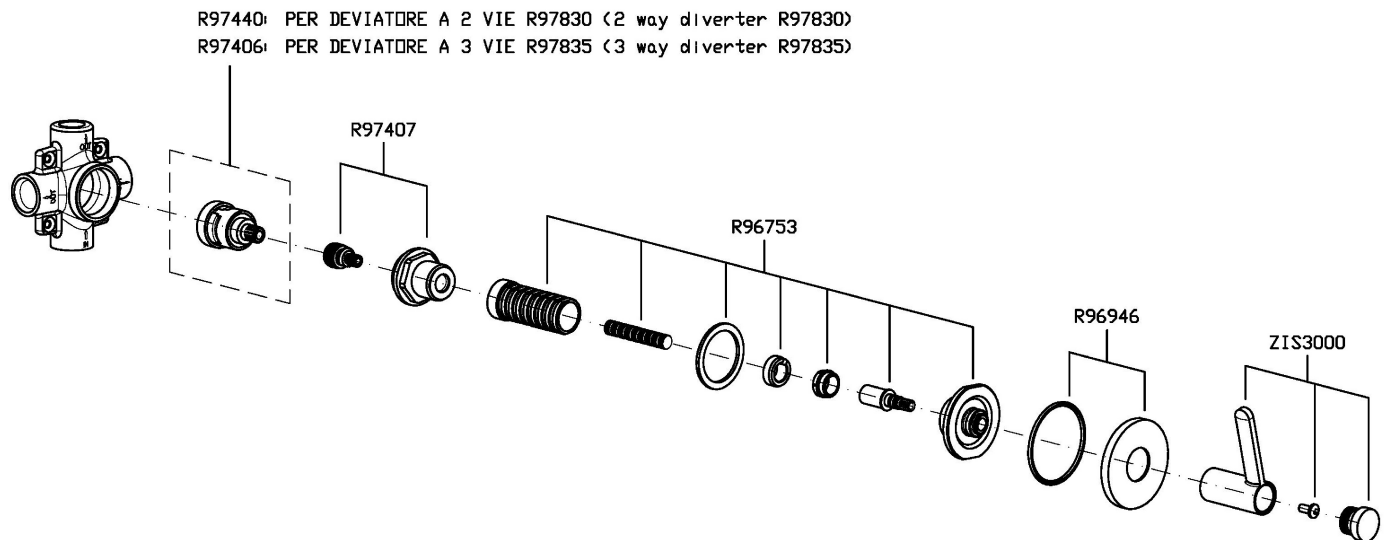

ISY22

ZIS3756

Portate / Flowrates (lt/min)

PRESSIONE PRESSURE	1 BAR	2 BAR	3 BAR	4 BAR	5 BAR
DEVIATORE <i>P1</i>	16,7	24	29,2	33,8	37,8
<i>P2</i>					
<i>P3</i>					
<i>P4</i>					
<i>P5</i>					

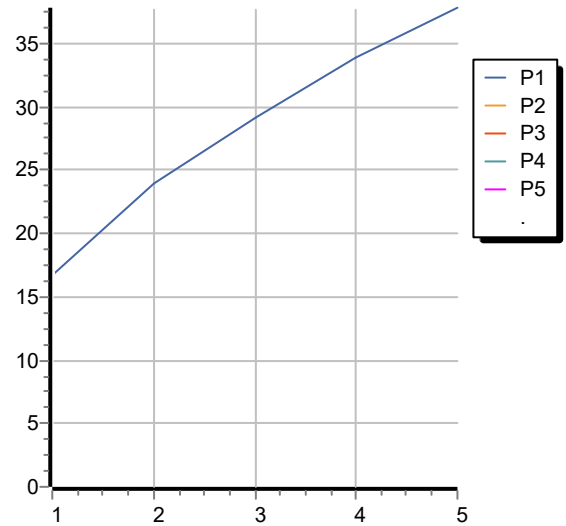

ISY22

ZIS3756

Pesi e Misure / Weights and Sizes

Peso (Kg) Weight (lb)	0,69 (Kg)	1,52 (lb)
Volume test (dc3) - (in3)	1,21 (dc3)	73,84 (in3)
h (mm) - (in)	73,00 (mm)	2,87 (in)
L1 (mm) - (in)	127,00 (mm)	5,00 (in)
L2 (mm) - (in)	130,00 (mm)	5,12 (in)

