

JINGLE

ZIN778

Miscelatore monocomando vasca-doccia incasso. / Built-in single lever bath-shower mixer.



Miscelatore monocomando vasca-doccia incasso con deviatore a 2 vie a rotazione.

Built-in single lever bath-shower mixer with 2 way rotation diverter.

R96725

Parte incasso / Built-in part



JINGLE

ZIN778

Finiture / Finishes

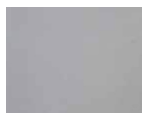

Croma / Chrome



C3

Nickel Spazzolato / Brushed Nickel



C8

Nickel Lucido / Polished Nickel



C40

Oro / Gold

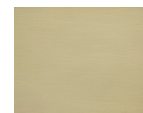

C41

Oro spazzolato / Brushed Gold

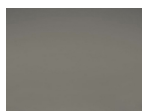

C50

Metal Black / Metal Black

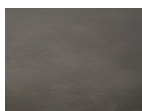

C51

Metal Black spazzolato / Brushed Metal Black



W1

Bianco Opaco Goffrato / Embossed Matt White



N1

Nero Opaco Goffrato / Embossed Matt Black

Note / Notes

JINGLE

ZIN778

Disegno Complessivo / Overall Drawing

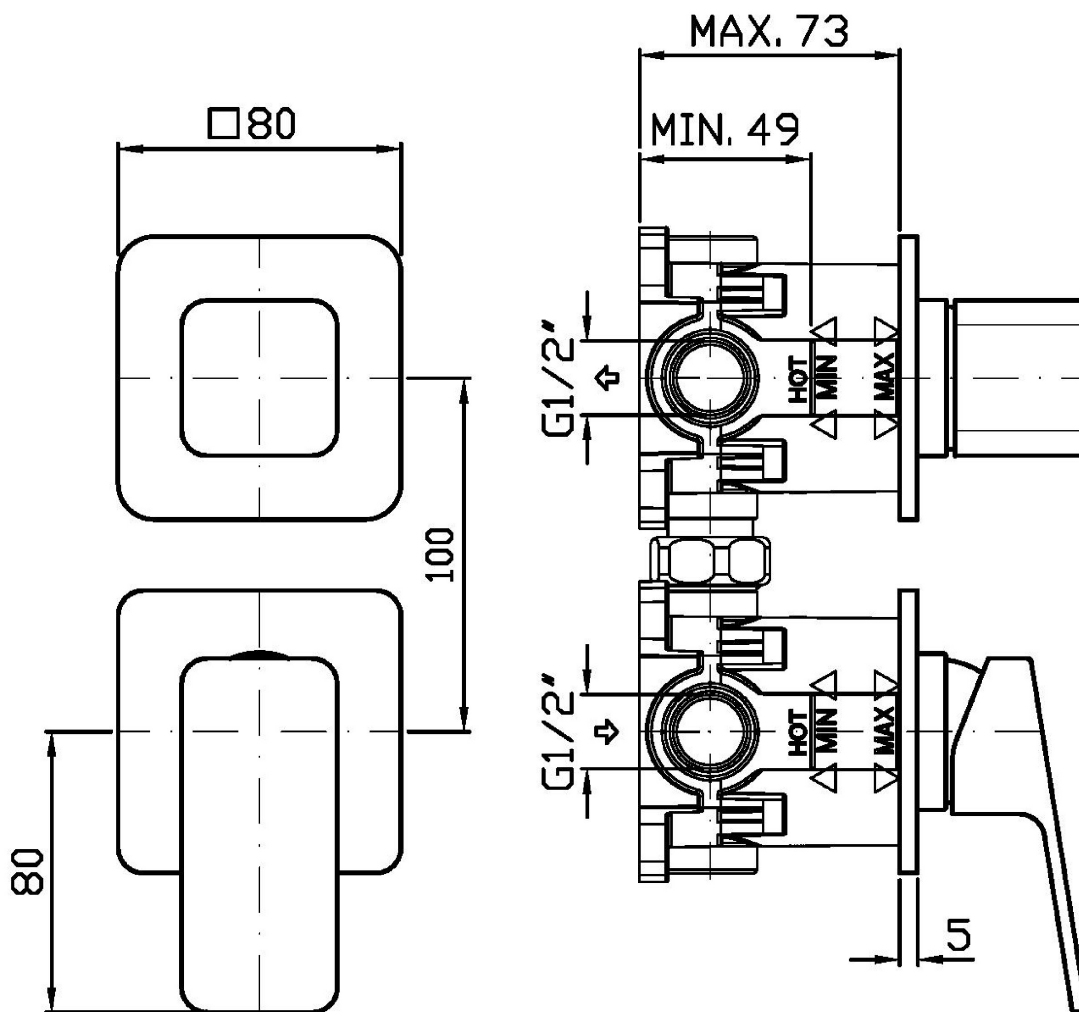

JINGLE

ZIN778

Esplosi / Exploded

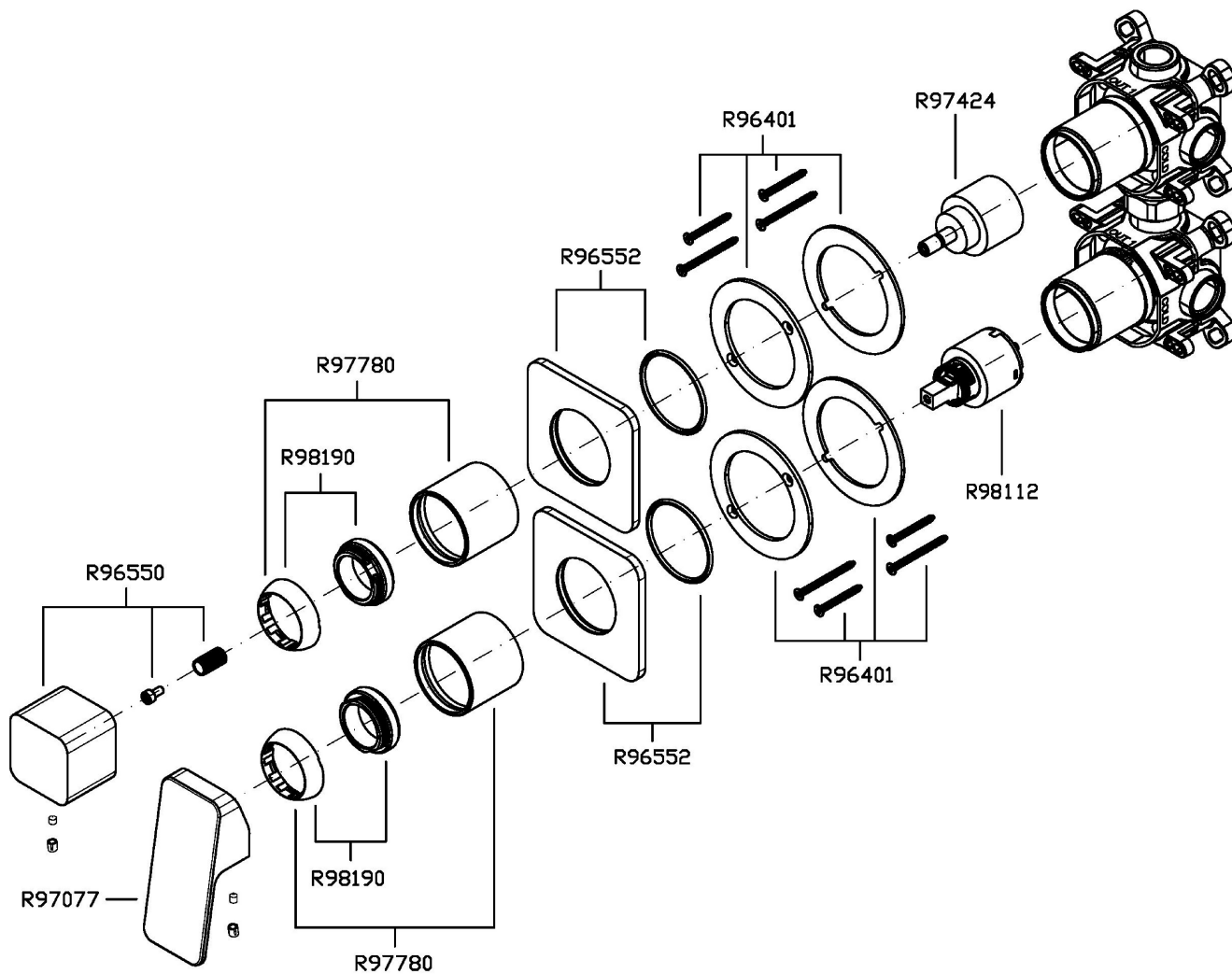

JINGLE

ZIN778

Portate / Flowrates (lt/min)

| PRESSIONE PRESSURE | 1 BAR | 2 BAR | 3 BAR | 4 BAR | 5 BAR |
|---|-------|-------|-------|-------|-------|
| USCITA PRIMARIA PRIMARY OUTLET P ₁ | 10,9 | 18,9 | 20 | 22,8 | 25,8 |
| USCITA SECONDARIA SECONDARY OUTLET P ₂ | 10,9 | 18,9 | 20 | 22,8 | 25,8 |
| P ₃ | | | | | |
| P ₄ | | | | | |
| P ₅ | | | | | |

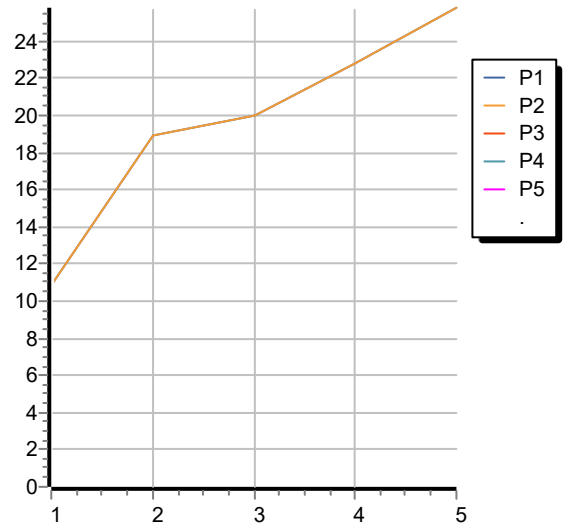

JINGLE

ZIN778

Pesi e Misure / Weights and Sizes

| | | |
|-------------------------------|---------------|----------------|
| Peso (Kg) Weight (lb) | 0,90 (Kg) | 1,98 (lb) |
| Volume test (dc3) - (in3) | 3,32 (dc3) | 202,60 (in3) |
| h (mm) - (in) | 93,00 (mm) | 3,66 (in) |
| L1 (mm) - (in) | 162,00 (mm) | 6,38 (in) |
| L2 (mm) - (in) | 220,00 (mm) | 8,66 (in) |

