

## HELM

ZHM761.X

Batteria lavabo incasso a 3 fori. / 3 hole built-in basin mixer.

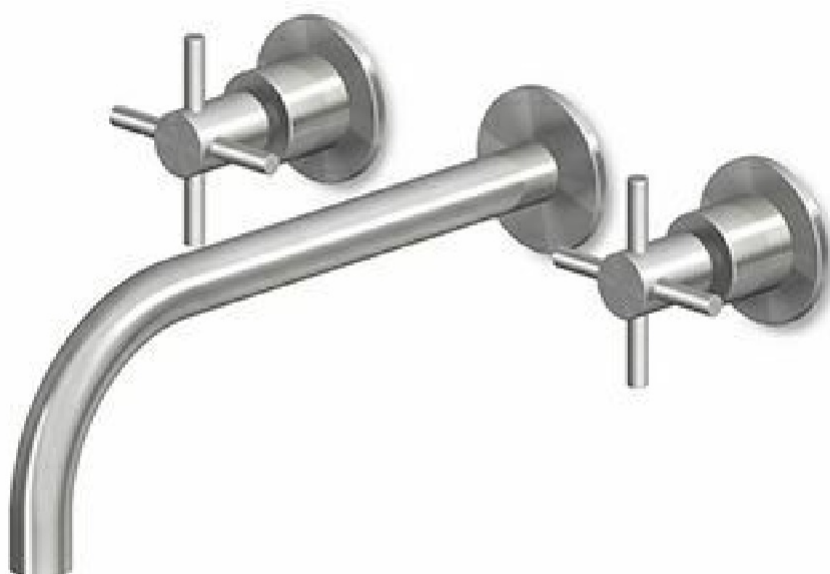

Batteria lavabo incasso a 3 fori in acciaio inox AISI 316L, con aeratore. Lunghezza bocca 230 mm. Water Saving - portata d'acqua uguale o inferiore a 6 l/min.

3 hole built-in basin mixer in AISI 316L stainless steel, with aerator. Spout L. 230 mm. Water Saving - water flow rate of 6 l/min or less.

R99500

Parte incasso corpo unico, interasse 200 mm / Assembled built-in part, interaxe 200 mm.





R99504

Parte incasso con elementi liberi, distanza variabile / Built-in part, not assembled, variable distance.

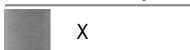
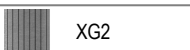
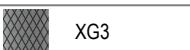
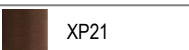
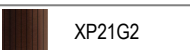
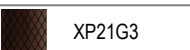
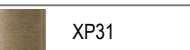
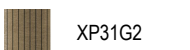
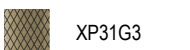

## Finiture / Finishes

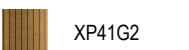
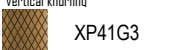
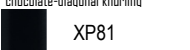
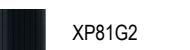
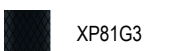
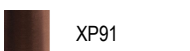
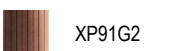
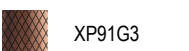
|  |   |  |   |  |   |   |
|--|---|--|---|--|---|---|
|  X<br>Acciaio inox spazzolato / Brushed stainless steel                                  |  XG2<br>Acciaio inox spazz.-godr. verticale / Br. stainless steel-Vertical knurling      |  XG3<br>Acciaio inox spazz.-godronatura diagonale / Br. stainless steel-diagonal knurling |  XP21<br>Brushed PVD chocolate / Brushed PVD chocolate                             |  XP21G2<br>Brushed PVD chocolate godronatura verticale / Brushed PVD chocolate vertical knurling |  XP21G3<br>Brushed PVD chocolate-godronatura diagonale / Brushed PVD chocolate-diagonal knurling |  XP31<br>Brushed PVD British gold / Brushed PVD British gold                           |
|  XP31G2<br>Br. PVD British gold-godr. verticale / Br. PVD British gold-vertical knurling |  XP31G3<br>Br. PVD British gold-godr. diagonale / Br. PVD British gold-diagonal knurling |  XP41<br>Brushed PVD gold / Brushed PVD gold  |  XP41G2<br>Br. PVD gold-godronatura verticale / Brushed PVD gold-vertical knurling |  XP41G3<br>Br. PVD gold-godr. diagonale / Br. PVD gold-diagonal knurling                         |  XP81<br>PVD Brushed Total Black / PVD Brushed Total Black                                       |  XP81G2<br>Br. PVD Total Black-godr. verticale / Br. PVD Total Black-vertical knurling |
|  XP81G3<br>Br. PVD Total Black-godr. diagonale / Br. PVD Total Black-diagonal knurling   |  XP91<br>Brushed PVD copper / Brushed PVD copper   |  XP91G2<br>Br. PVD copper-godr. verticale / Br. PVD copper-vertical knurling              |  XP91G3<br>Br. PVD copper-godr. diagonale / Br. PVD copper-diagonal knurling       |  |   |   |

## HELM

ZHM761.X

Disegno Complessivo / Overall Drawing

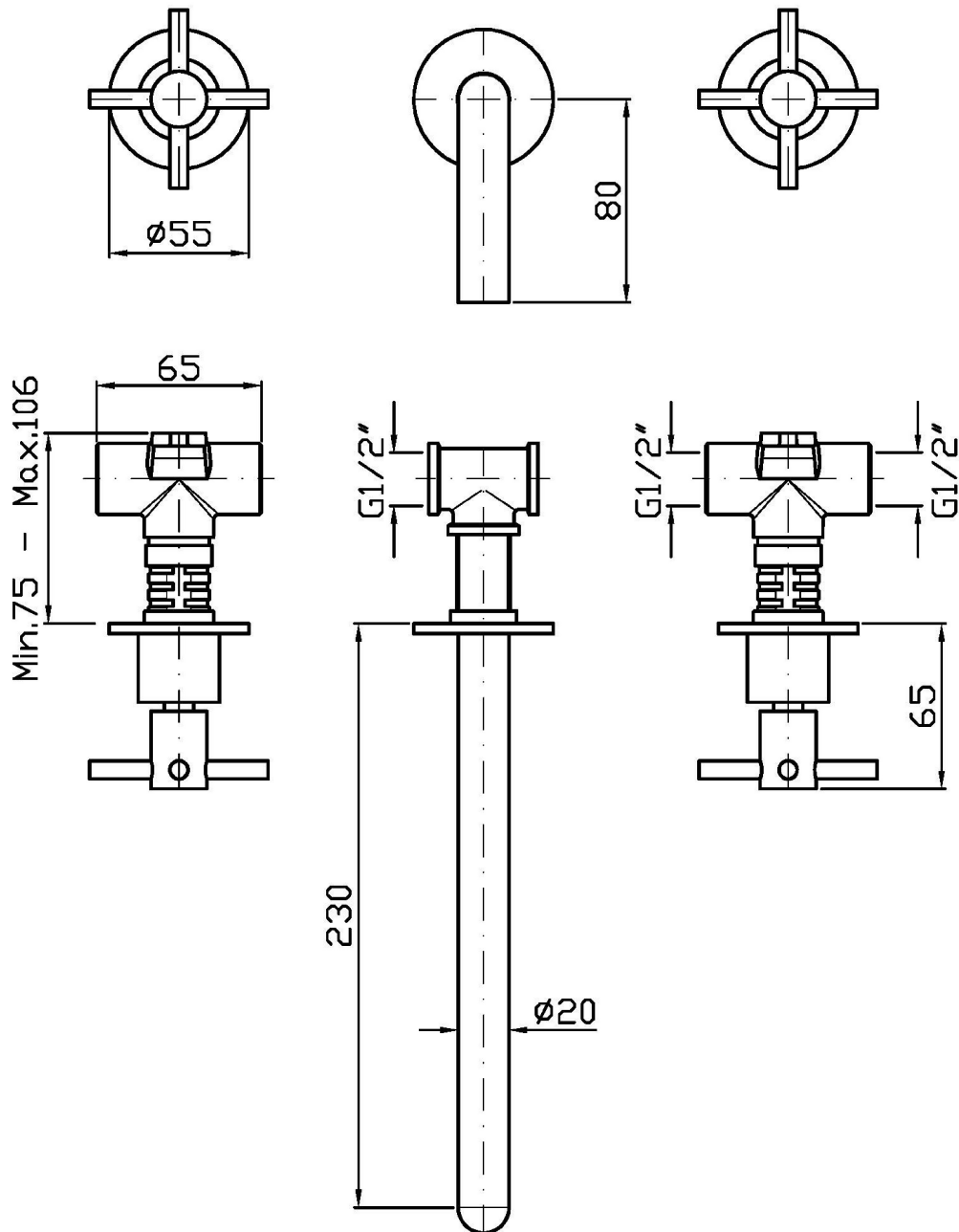

## HELM

ZHM761.X

Esplosi / Exploded

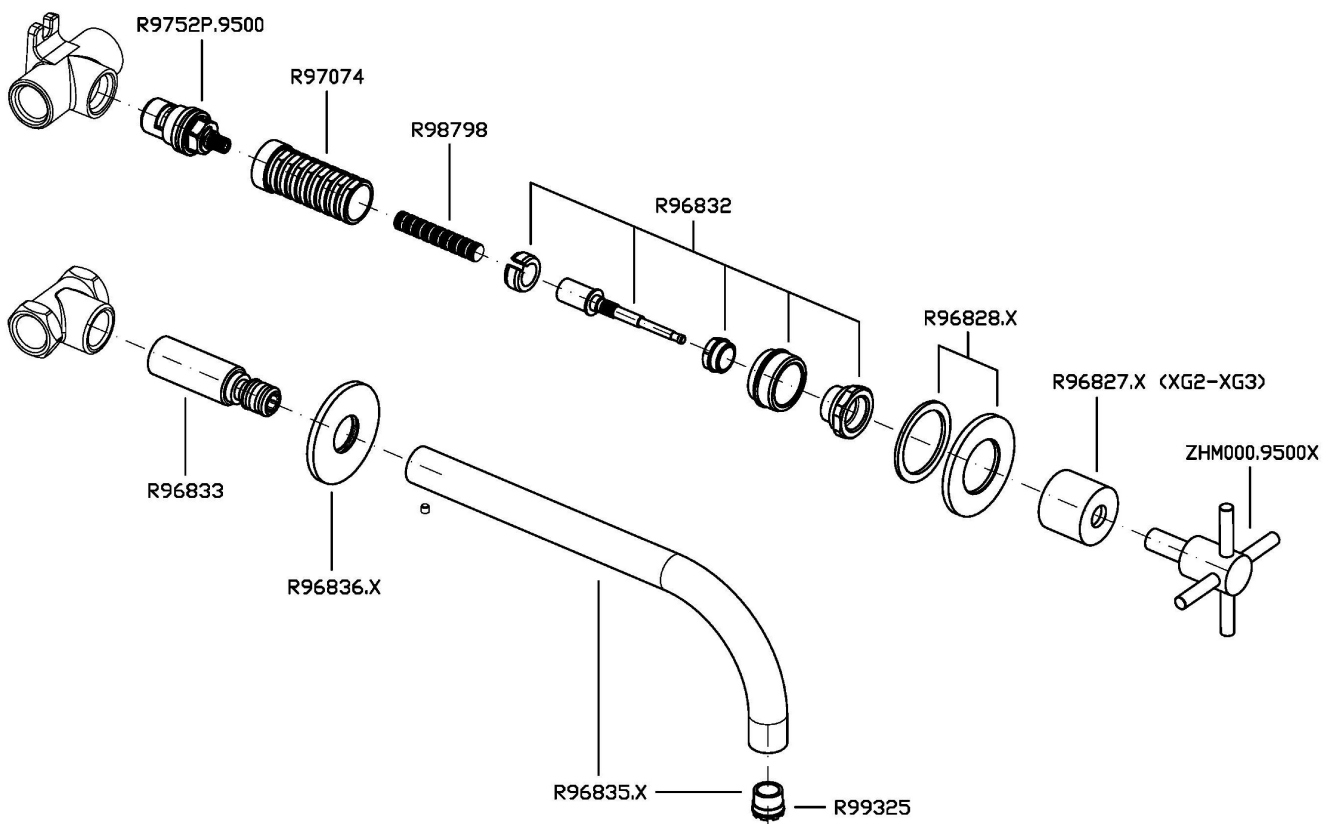

## HELM

### ZHM761.X Portate / Flowrates (lt/min)

| PRESSIONE<br>PRESSURE | 1 BAR | 2 BAR | 3 BAR | 4 BAR | 5 BAR |
|-----------------------|-------|-------|-------|-------|-------|
| P1<br>LAVABO<br>BASIN | 4     | 4,6   | 4,8   | 4,9   | 5     |
| P2                    |       |       |       |       |       |
| P3                    |       |       |       |       |       |
| P4                    |       |       |       |       |       |
| P5                    |       |       |       |       |       |

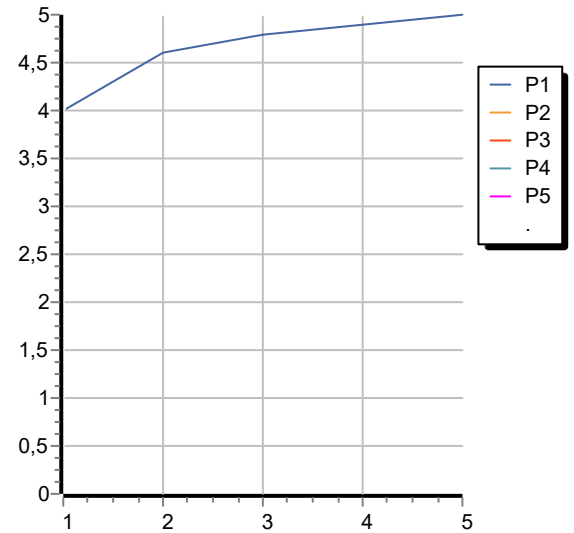

## HELM

### ZHM761.X Pesi e Misure / Weights and Sizes

|                               |               |                |
|-------------------------------|---------------|----------------|
| Peso ( Kg ) Weight ( lb )     | 1,85 ( Kg )   | 4,08 ( lb )    |
| Volume test ( dc3 ) - ( in3 ) | 7,50 ( dc3 )  | 457,68 ( in3 ) |
| h ( mm ) - ( in )             | 90,00 ( mm )  | 3,54 ( in )    |
| L1 ( mm ) - ( in )            | 250,00 ( mm ) | 9,84 ( in )    |
| L2 ( mm ) - ( in )            | 333,00 ( mm ) | 13,11 ( in )   |

