

SHOWER

Z93795.X





Presa acqua. / Wall elbow.

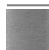

Presa acqua in acciaio inox, da 1/2"x1/2", per gruppo incasso.

stainless steel wall elbow, 1/2"x1/2".

Finiture / Finishes

 X	 XP21	 XP31	 XP41	 XP81	 XP91
Acciaio inox spazzolato / Brushed stainless steel	Brushed PVD chocolate / Brushed PVD chocolate	Brushed PVD British gold / Brushed PVD British gold	Brushed PVD gold / Brushed PVD gold	PVD Brushed Total Black / PVD Brushed Total Black	Brushed PVD copper / Brushed PVD copper

SHOWER

Z93795.X

Disegno Complessivo / Overall Drawing

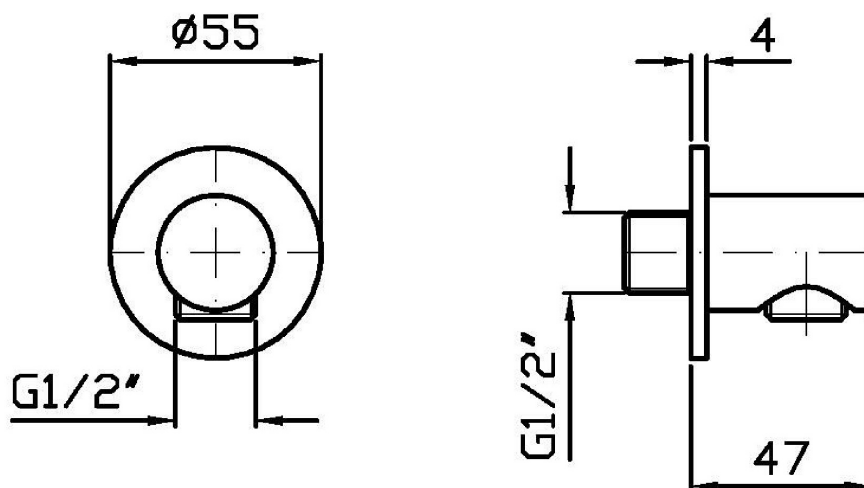

SHOWER

Z93795.X

Certificazioni / Certifications

INGHILTERRA

Kiwa Regulation 4

SHOWER

Z93795.X

Portate / Flowrates (lt/min)

PRESSIONE PRESSURE	1 BAR	2 BAR	3 BAR	4 BAR	5 BAR
1 RUBINETTO APERTO <i>P1</i>	18,6	25,9	30,7	35,2	38,6
<i>P2</i>					
<i>P3</i>					
<i>P4</i>					
<i>P5</i>					

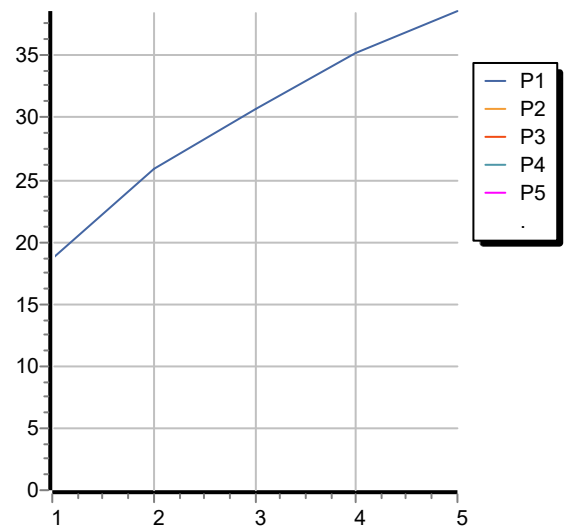

SHOWER

Z93795.X

Pesi e Misure / Weights and Sizes

Peso (Kg) Weight (lb)	0,35 (Kg)	0,77 (lb)
Volume test (dc3) - (in3)	0,35 (dc3)	21,36 (in3)
h (mm) - (in)	50,00 (mm)	1,97 (in)
L1 (mm) - (in)	75,00 (mm)	2,95 (in)
L2 (mm) - (in)	95,00 (mm)	3,74 (in)

